



Spring Is Here!

Let's Play Bingo!



Here is all you need:

- Good eyes
- Bingo cards - Play all cards.

What will make this more FUN?

- Bird feeder placed in front of a window (see attached examples that are easy to make at home)
- Bird feed (plus look around your kitchen)
- Binoculars
- Going for a walk or hike outside
- Common Winter Feeder Birds of Alaska (see attachment)

Share your findings:

- A Bingo - 3 in a row or diagonal sightings
- A "blackout"
- Bird Sightings Log
- Share your findings on SVT Community Services Facebook page. Take a photo and post it or email it to Shannon Custer @ scuster@svt.org

Alaska Winter/Spring Bird Bingo

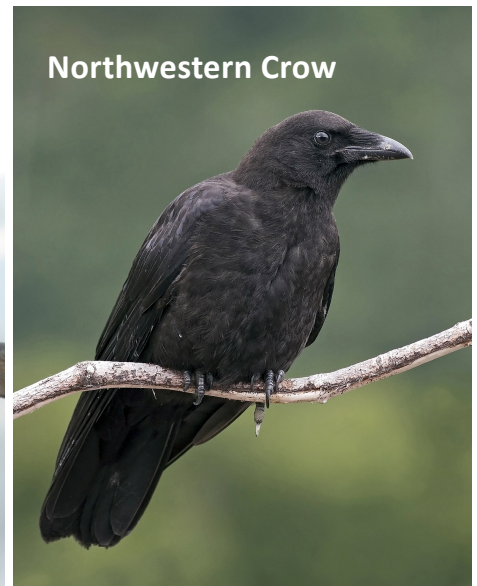

Alaska Winter/Spring Bird Bingo

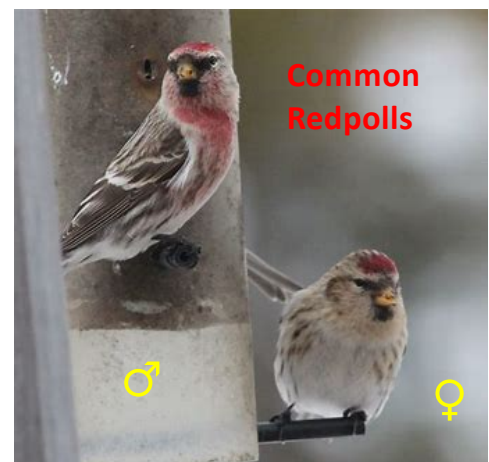
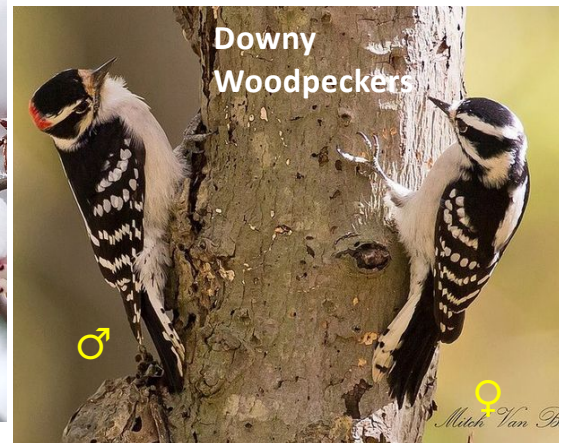

♂ male ♀ female symbols

Alaska Winter/Spring Bird Bingo

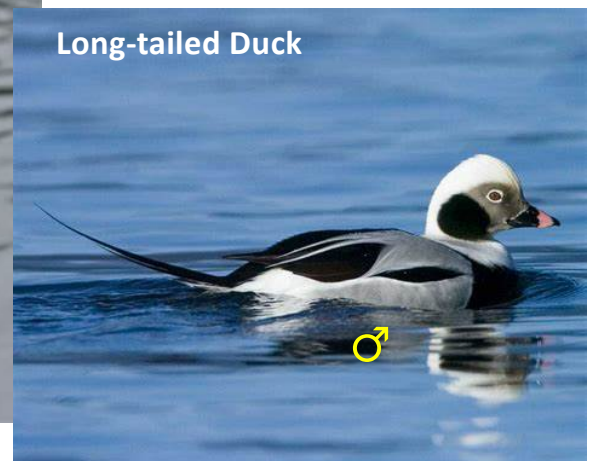
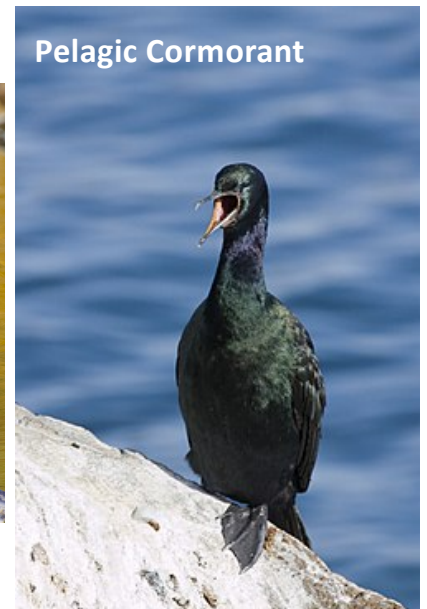
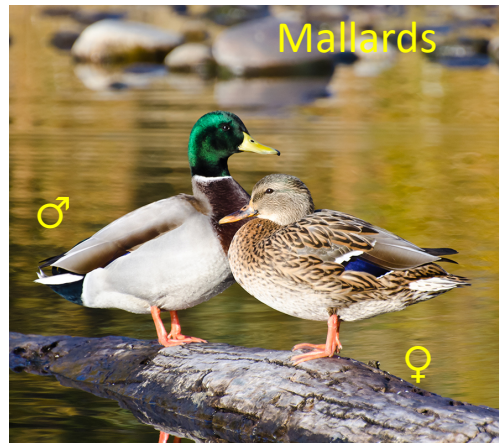

♂ male ♀ female symbols

Alaska Winter/Spring Bird Bingo

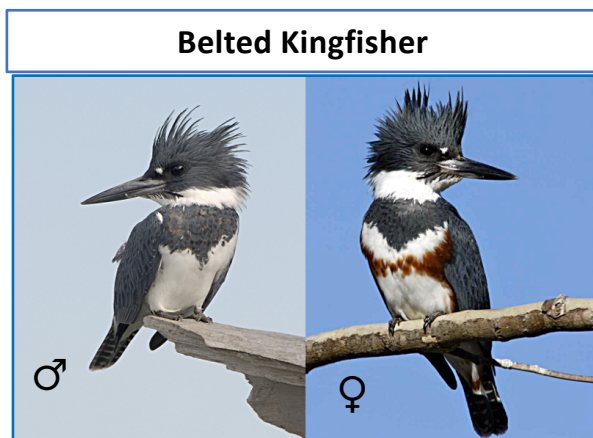

♂ male ♀ female symbols

Fun bird feeders to make at home

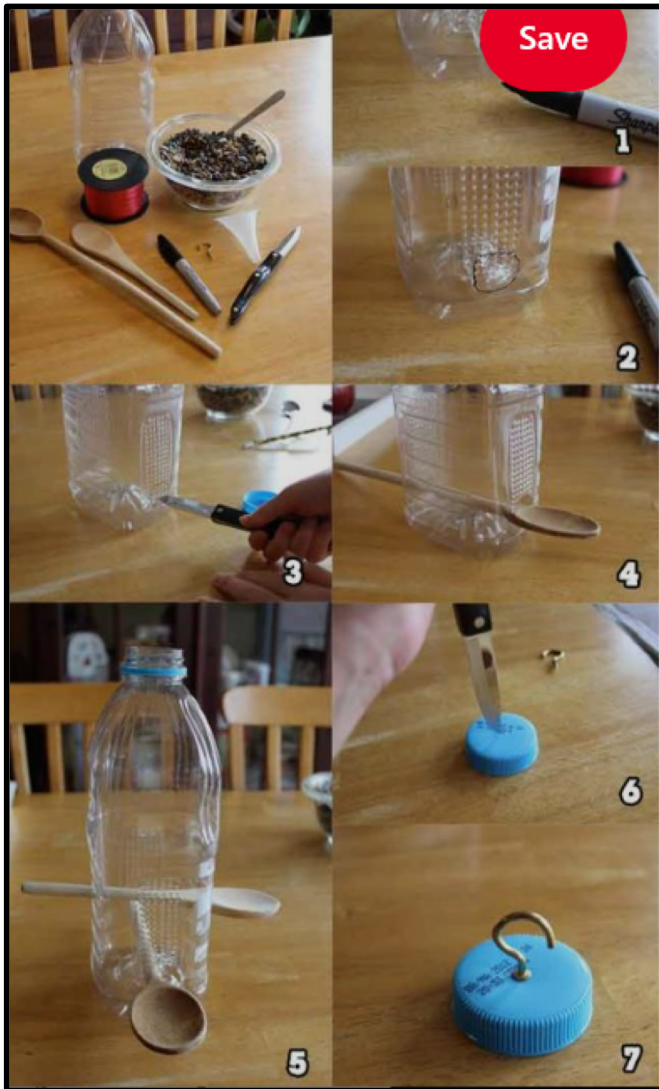

Check out this bottle feeder demonstration:
https://www.youtube.com/watch?v=2RwLV1_tx4E



Cut orange in half; remove pulp; make holes to push sticks through; add string or yarn; fill with seeds.



Make sure an adults washes this Chlorox bottle and assists with the cutting.



Materials:

- toilet paper rolls
- sturdy sticks, 2 per roll, 6-8 inches long
- bird seed
- peanut butter
- string or ribbon
- hole punch

Good food for your feeder: Birds such chickadees and woodpeckers are attracted by animal fat or suet and peanut butter mixed with melted animal fat and cornmeal or oatmeal (so that it isn't too sticky for birds' bills). Seed-eating birds that can be attracted to feeders include pine siskins, sparrows, grosbeaks, redpolls, and crossbills. These species also eat suet, but seeds will attract them to your feeder. Unsalted sunflower seeds, thistle seeds, nyjer, raw crushed peanuts, millet, scratch feed, various grains are welcomed. Commercial wild bird seed mixes for the lower 48 often contain filler seeds that are not eaten by many species. Save-U-More and Wagon Wheel carry the above recommended seeds.

See the following article with more tips for winter bird feeding. And remember to bring your feeders in if they are accessible to bears, once they come back out!

<http://www.adfg.alaska.gov/index.cfm?adfg=livingwithbirds.winterfeeding>



Suet

1 pound lard

3 cups cornmeal

½ cup wheat flour

Add in a few of these: sunflower seeds, bird seed, raisins, millet, rolled oats, nuts, berries, etc.

Melt lard, add cornmeal and flour and add-ins; let cool slightly; pour into waxpaper lined plastic containers. Let containers setup in the refrigerator. Place suet in a mesh bag or wrap in netting; then hang up for the winter birds.



Peanut butter/cornmeal mix

¾ cup peanut butter

¾ cup nyjer/thistle redpoll feed

2 - 3 cups cornmeal depending on the type of peanut butter you use.

Mix together and spread on and between the scales of a pine cone.

[illegible]

Common Winter Feeder Birds of Alaska

Downy Woodpecker
Picoides pubescens

Female



Male

Hairy Woodpecker
Picoides villosus

Female



Three-toed Woodpecker
Picoides tridactylus

Male



Black-capped Chickadee
Poecile atricapilla



Chestnut-backed Chickadee
Poecile rufescens



Red-breasted Nuthatch
Sitta canadensis



Rock Dove (Feral pigeon)
Columba livia
(30% life size)



Steller's Jay
Cyanocitta stelleri



Boreal Chickadee
Poecile hudsonia



Black-billed Magpie
Pica hudsonia



Common Raven
Corvus corax
(25% life size)



adult



Slate-colored Junco
Junco hyemalis



White-crowned Sparrow
Zonotrichia leucophrys

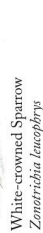

Bohemian Waxwing
Bombycilla garrulus



Common Redpoll
Carduelis flammica



Pine Siskin
Carduelis pinus



Female



Common Redpoll
Carduelis flammica



This poster was funded in part by the Warchable Wildlife Conservation Trust, a joint program of the Alaska Department of Fish and Game and the Alaska Conservation Foundation. Additional support came from the Alaska Bird Observatory and Alaska Feed Company.



© 2002 Alaska Bird Observatory

Nearly 53 million Americans feed wild birds. The birds depicted on this poster are among the most common species that visit bird feeders during winter in Alaska. Birds are organized by related species and are approximately 40% of life size unless otherwise noted. Some species may only be found in limited areas of the state. For example, only Black-capped and Boreal Chickadees are common at feeders in interior Alaska, while Chestnut-backed Chickadees are common in southeastern Alaska.

All artwork was created by George C. West. To view more of the artist's work, visit his web site at <http://www.birchsidestudios.com>. The Alaska Bird Observatory is a nonprofit organization dedicated to advancing the appreciation, understanding, and conservation of birds and their habitats through research and education. Visit <http://www.alaskabird.org> or call (907) 451-7159 for more information about the Alaska Bird Observatory.



This poster was funded in part by the Warchable Wildlife Conservation Trust, a joint program of the Alaska Department of Fish and Game and the Alaska Conservation Foundation. Additional support came from the Alaska Bird Observatory and Alaska Feed Company.



© 2002 Alaska Bird Observatory